

GC170BN_R

BAR CLAMP FOR HOCKEY PUK DEVICES

- Pre-loaded to the specific clamping force
- Maximum device diameter: L = 153 mm
- Surface passivation to provide extra protection
- Various lengths of bolts and insulators
- Round shaped head for even clamping force application
- User friendly clamping force indicator
- UL94 certified insulation material
- RoHS compliant



Characteristic		Unit	Types	Testing conditions	Values		
					Min	Typ	Max
m	Mass	g	GC170BN_R				
F	Clamping Force	kN				90	
ΔF	Clamping Force tolerance						$\pm 10\%$
V _{INS}	Insulation Voltage	V		50 Hz, RMS, 60 s		3000	
	Insulating Material		Bolt sleeves		G11		
			Insulating plates		SMC		
	UL Files		G11		E37920		
			SMC		E69414		
T	Operating temperature range	°C	G11		-30		180
			SMC		-30		155
T _{stg}	Storage temperature range	°C	G11		-30		180
			SMC		-30		155
D _s	Surface creepage distance	mm			11.5		
D _a	Air strike distance	mm					
CTI	Comparative Tracking Index	V	G11	According to IEC60112		500	
			SMC	According to IEC60112		600	
	Flammability		G11	UL94 HB Flame class rating		1.4	
			SMC	UL94 V0 Flame class rating		1.5	

ORDERING INFORMATION TABLE

Use this part numbering system to order

GC170	B	N	B	A	90	R
(1)	(2)	(3)	(4)	(5)		

(1) Construction type:	B = with reaction bar
(2) Insulator position:	N = on load bar
(3) Insulator code:	_ = no insulating cup other : see table below
(4) Bolt code:	_ = no bolt other : see table below
(5) Clamping force (in kN):	90 kN

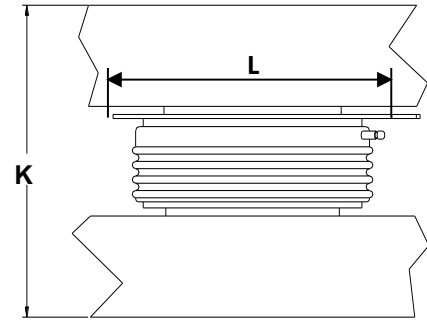

K: Total thickness of the assembly to be clamped
L: Max inner diameter allowable

Type GC170BN...R: suggested insulator/bolt types

Allowed clearance S _{Min} [mm]	Insulator choice		Bolt choice	
	(3)	Ins. Length [mm]	(4)	Bolt Length [mm]
75	A	180	A	260
85	B	190	B	270
95	C	200	C	280
105	D	210	D	290
115	E	220	E	300
125	F	230	F	310

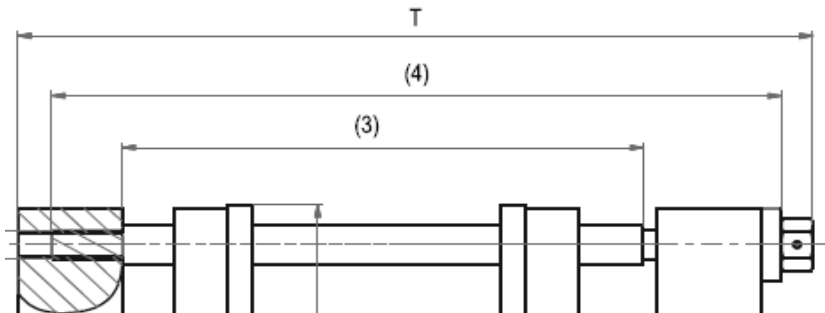

BAR CLAMP OUTLINES

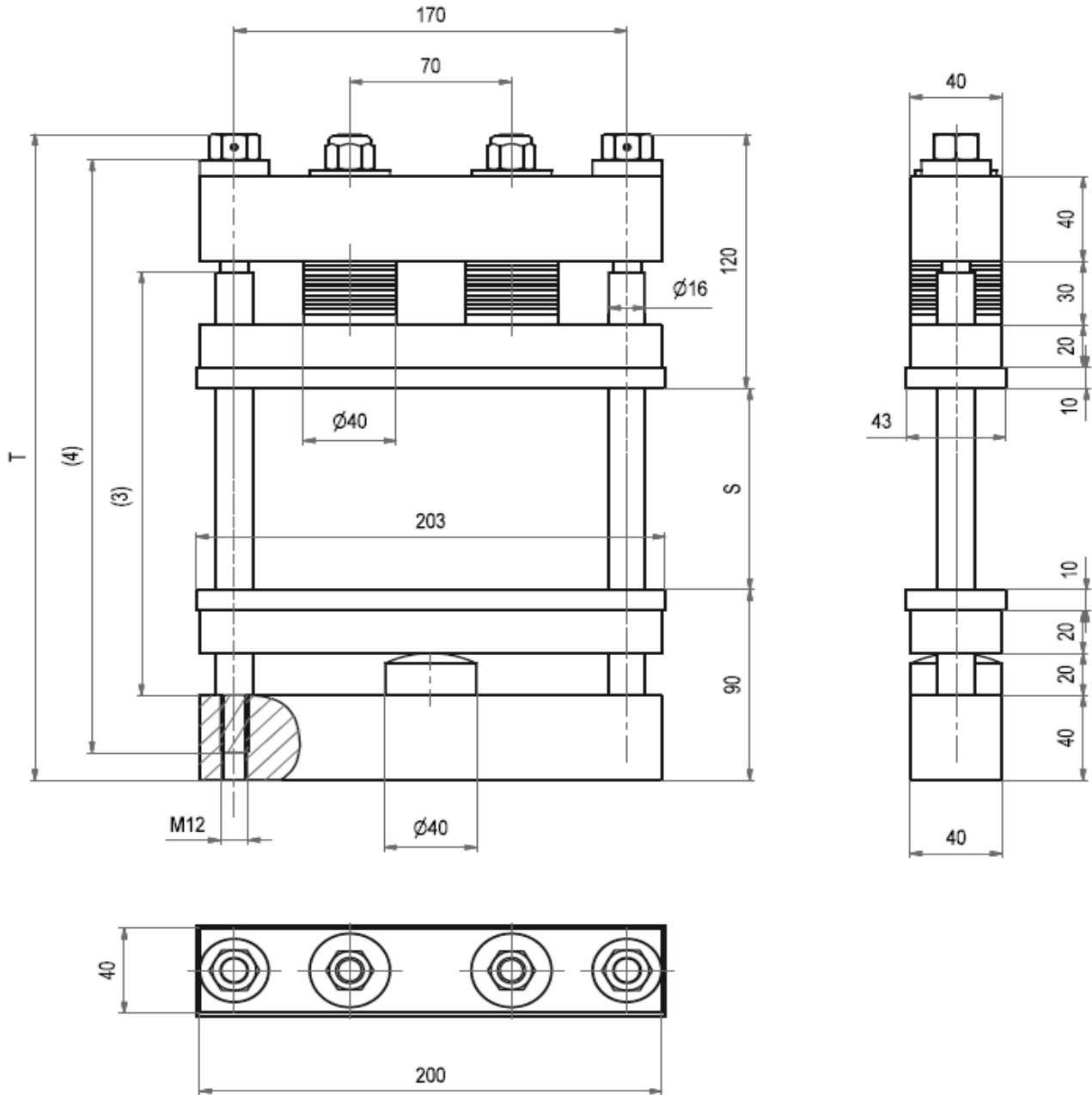

Dimensions in mm - Tolerances according to ISO 2768 MK