



GEMM_D

THREE PHASE STATIC EXCITER

Fuse protection on mains
 Fuse holder / breaker for safety
 Natural air cooling for improved reliability

LINE VOLTAGE UP TO 575 V
DC OUTPUT CURRENT 80 A

			GEMM3D08..
Line to line voltage			575 V

BRIDGE CHARACTERISTICS

Characteristic		Conditions		Value
I _{DC}	DC output current	T _a = 40 °C		80 A
I _{DC}	DC output current	T _a = 50 °C		75 A
V _{INS} (rms)	Insulation voltage			3000 V
P	Total power dissipation, max			270 W

DIODE CHARACTERISTICS

V _{RRM}	Blocking Voltage	T _j = 150 °C			1600 V
------------------	------------------	-------------------------	--	--	--------

MECHANICAL AND THERMAL CHARACTERISTICS

W	Width				213 mm
D	Depth	fuse holder close (open)			122 (150) mm
H	Height				553 mm
m	Mass				kg
T _a max	Max amb. op. Temp.				40 °C
T _{stg}	Storage temperature				-40 / 60 °C

FUSE TYPE 22 x 58 mm gR 690 V

			A	B	C
I _{NF}	Rated current		40 A	50 A	63 A
I ² _t	Total I ² _t	At 660 V	0.61 kA ² s	0.91 kA ² s	0.116 kA ² s

			D	E	F
I _{NF}	Rated current		80 A	100 A	125 A
I ² _t	Total I ² _t	At 660 V	4.4 kA ² s	8.9 kA ² s	22 kA ² s

CURRENT TRANSFORMER GTA01005-02

N	Turns ratio		125 - 250 - 500 :1
I _n	Nominal current	RMS value	25 - 50 - 100 A
R _L	Load resistance		20 Ω
V _o	Max RMS output voltage	R = 20 Ω	4 V
V _{ins}	RMS insulation voltage	50 Hz - 60 s	4 kV

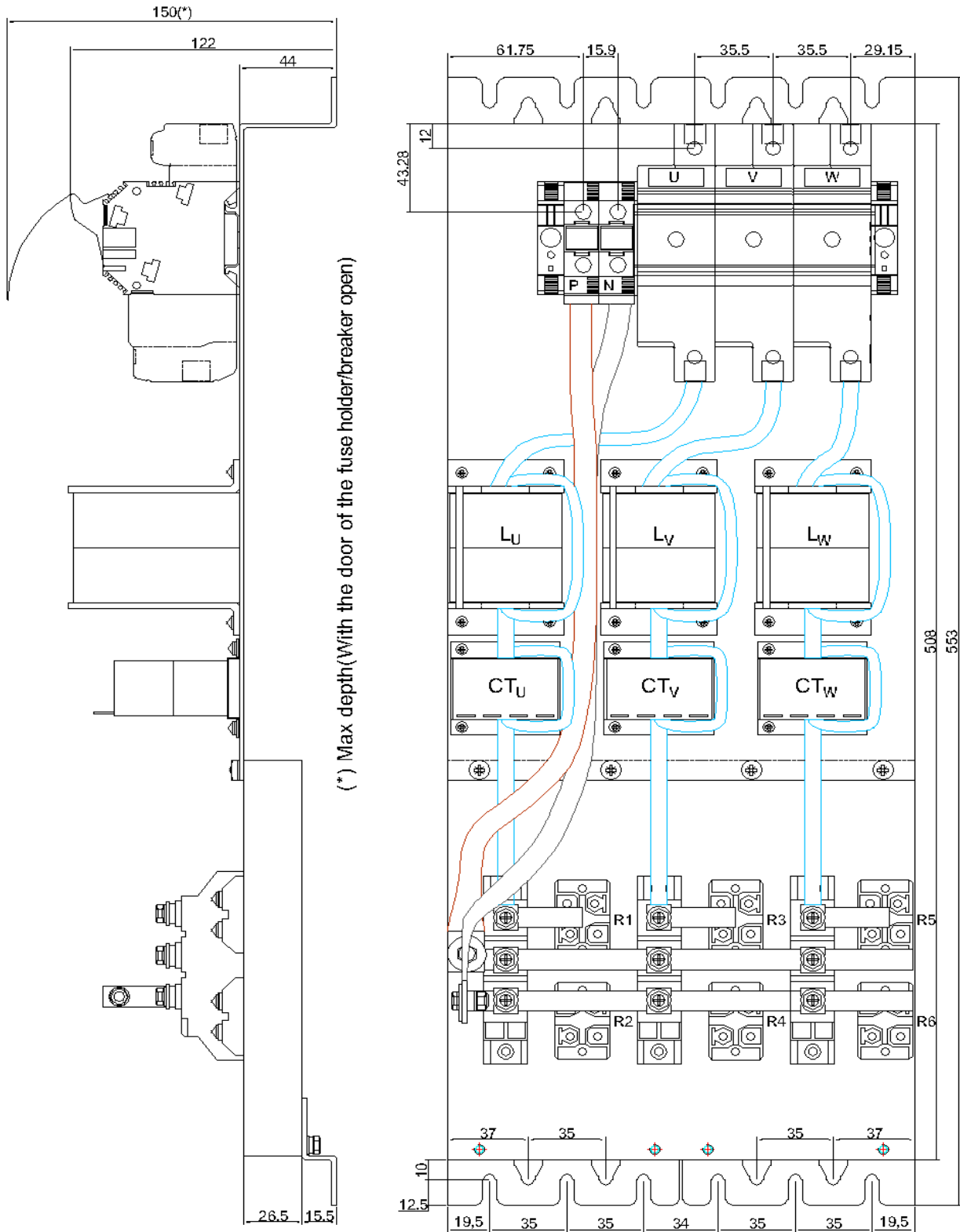

In the interest of product improvement Green Power Solutions reserves the right to change any specification given in this data sheet without notice.

Six pulse uncontrolled rectifier bridge circuit

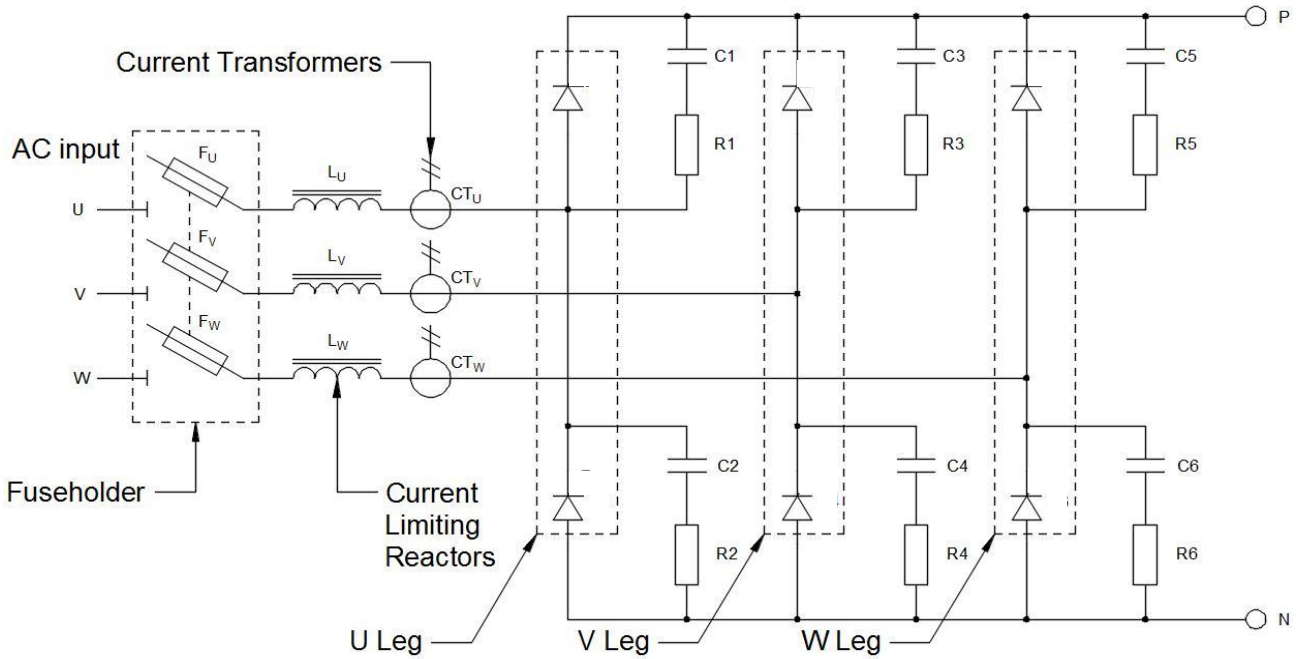

PART-NUMBERING SYSTEM

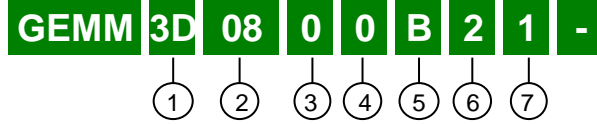

- ① Circuit configuration - see table below (*)
- ② Output current / 10
- ③ 0 = no CT - 2 = 2 CT's (on phases U and W) - 3 = 3 CT's
- ④ number of turns around CT: 0, 1, 2, 3
- ⑤ fuse choice : A,B,C,D,E,F
- ⑥ number of current limiting reactors: 0, 2
- ⑦ number of turns around current limiting reactors: 0, 1, 2

The number of turns is calculated as number of times the lead passes through the center

(*) Circuit configuration table	
3D	six pulse uncontrolled bridge

In the interest of product improvement Green Power Solutions reserves the right to change any specification given in this data sheet without notice.