



GEMM_T

THREE PHASE STATIC EXCITER

Fuse protection on mains
 Fuse holder / breaker for safety
 Natural air cooling for improved reliability

LINE VOLTAGE UP TO 575 V
DC OUTPUT CURRENT 61 A

			GEMM3T06..
Line to line voltage			575 V

BRIDGE CHARACTERISTICS

Characteristic		Conditions		Value
I _{DC}	DC output current	T _a = 40 °C		61 A
I _{DC}	DC output current	T _a = 50 °C		54 A
V _{INS} (rms)	Insulation voltage			3000 V
P	Total power dissipation, max			220 W

THYRISTOR CHARACTERISTICS

V _{GT}	Gate trigger voltage	T _j = 25 °C, V _D = 5 V		3 V
I _{GT}	Gate trigger current	T _j = 25 °C, V _D = 5 V		300 mA
dV/dt	Critical rate of rise off-state voltage	T _j = 125 °C		1000 V/μs
V _{D,RRM}	Blocking Voltage	T _j = 125 °C		1600 V

MECHANICAL AND THERMAL CHARACTERISTICS

W	Width			213 mm
D	Depth	fuse holder close (open)		122 (150) mm
H	Height			553 mm
m	Mass			kg
T _a max	Max amb. op. Temp.			40 °C
T _{stg}	Storage temperature			-40 / 60 °C

FUSE TYPE 22 x 58 mm gR 690 V

		A	B	C
I _{NF}	Rated current	40 A	50 A	63 A
I ² t	Total I ² t	At 660 V	0.61 kA ² s	0.91 kA ² s

		D	E	F
I _{NF}	Rated current	80 A	100 A	125 A
I ² t	Total I ² t	At 660 V	4.4 kA ² s	8.9 kA ² s

CURRENT TRANSFORMER GTA01005-02

N	Turns ratio		125 - 250 - 500 :1
I _n	Nominal current	RMS value	25 - 50 - 100 A
R _L	Load resistance		20 Ω
V _o	Max RMS output voltage	R = 20 Ω	4 V
V _{ins}	RMS insulation voltage	50 Hz - 60 s	4 kV

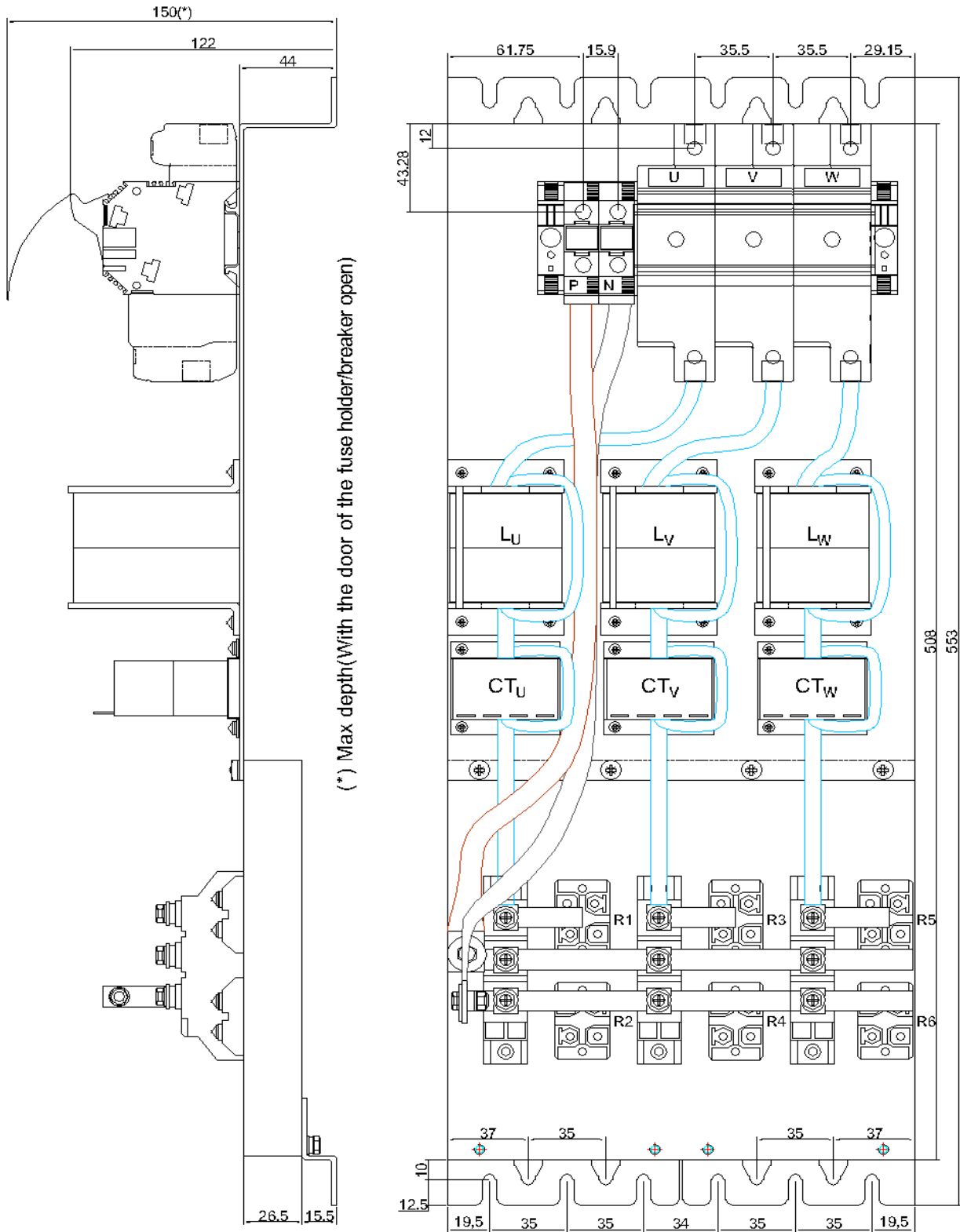

In the interest of product improvement Green Power Solutions reserves the right to change any specification given in this data sheet without notice.

Six pulse fully controlled rectifier bridge circuit

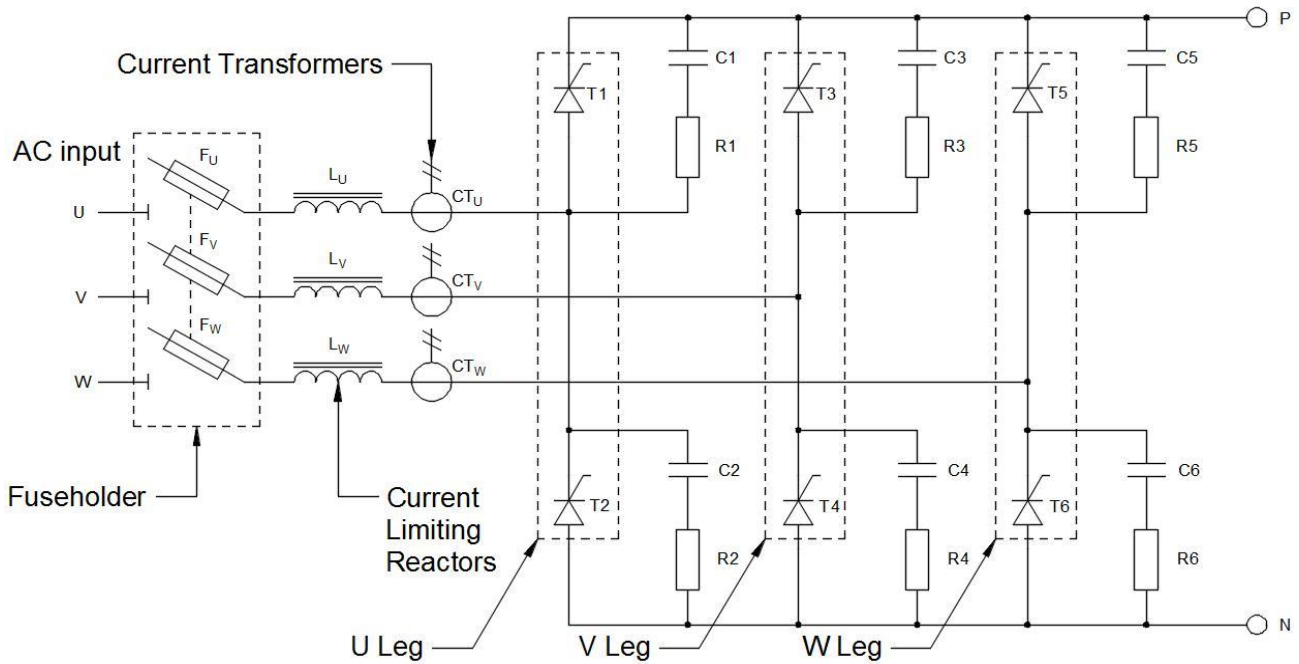

PART-NUMBERING SYSTEM

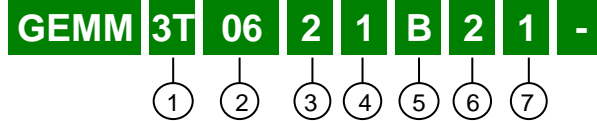

- ① Circuit configuration - see table below (*)
- ② Output current / 10
- ③ 0 = no CT - 2 = 2 CT's (on phases U and W) - 3 = 3 CT's
- ④ number of turns around CT: 0, 1, 2, 3
- ⑤ fuse choice : A,B,C,D,E,F
- ⑥ number of current limiting reactors: 0, 2
- ⑦ number of turns around current limiting reactors: 0, 1, 2

The number of turns is calculated as number of times the lead passes through the center

(*) Circuit configuration table	
3T	six pulse bridge fully controlled
3H	six pulse bridge half controlled - SCR high side

In the interest of product improvement Green Power Solutions reserves the right to change any specification given in this data sheet without notice.